

PAVEMENT AND CURB REHABILITATION PROJECT
MARIN AVE PHASE 2
(FROM KEY ROUTE BLVD TO TULARE AVE)
DEMOLITION PLAN

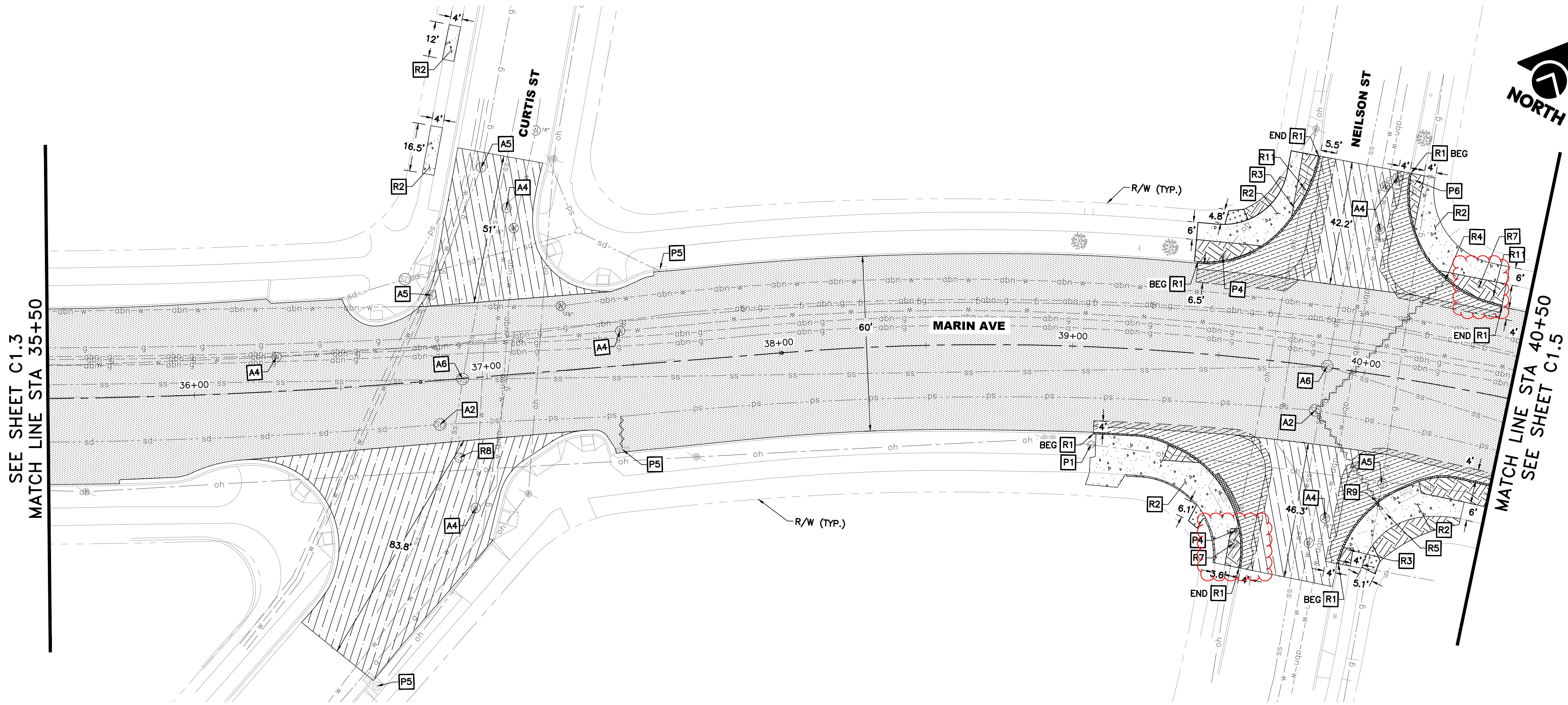

PLAN VIEW
SCALE: 1" = 20'

LEGEND

- SAWCUT AND REMOVE EX CONCRETE SIDEWALK, CURB RAMP, DRIVEWAY, AND BASE TO DESIGN SUBGRADE
- MILL EXISTING ASPHALT CONCRETE (2" THICK)
- MILL EXISTING ASPHALT CONCRETE (3" THICK)
- REMOVE EXISTING PLANTERS AND LANDSCAPING, INCLUDING HEADERBOARD

- SAWCUT AND REMOVE EX PRIVATE PROPERTY PATH. PRIOR TO REMOVAL, PHOTOGRAPH AND DOCUMENT EXISTING PATH CONDITIONS.
- SAWCUT AND REMOVE AC PAVING AND BASE TO DESIGN SUBGRADE
- SAWCUT AND REMOVE CONCRETE CURB, GUTTER, AND BASE TO DESIGN SUBGRADE
- FOLLOWING MILLING OPERATIONS AND PRIOR TO PERFORMING COLD-IN-PLACE RECYCLING, PERFORM 8" THICK AC BASE REPAIR PER DETAIL 4 ON SHEET G1.5. (1447 MARIN AVENUE)

- SAWCUT LINE
- ABANDON IN PLACE EX STORM DRAIN PIPE. CONTRACTOR TO FILL ABANDONED PIPE WITH SLURRY OR SAND FILL.
- REMOVE AND BACKFILL EX STORM DRAIN PIPE

CONSTRUCTION NOTES:

- R1 REMOVE CURB, GUTTER, AND BASE TO DESIGN SUBGRADE
- R2 REMOVE CONCRETE SIDEWALK, CURB RAMP, DRIVEWAY, AND BASE TO DESIGN SUBGRADE
- R3 SEE SIGNING AND STRIPING PLAN FOR IMPACT TO EXISTING POLES AND SIGNS.
- R4 REMOVE EX STORM DRAIN INLET
- R5 REMOVE EX STORM DRAIN MANHOLE/JUNCTION BOX
- R6 SEE TRAFFIC SIGNAL PLANS FOR IMPACTS TO EXISTING SIGNAL POLES, BOXES, AND EQUIPMENT
- R7 REMOVE EXISTING TREE AND GRIND ROOTS
- R8 PRIOR TO DEMOLITION, CONTRACTOR SHALL REFERENCE EXISTING MONUMENT/RR SPIKE AND SUBMIT CORNER RECORD TO COUNTY SURVEYOR. AFTER CONSTRUCTION ACTIVITIES, CONTRACTOR SHALL REESTABLISH THE MONUMENT AND SUBMIT FINAL CORNER RECORD TO COUNTY SURVEYOR. IN CONCRETE SIDEWALK, MONUMENT SHALL BE CITY-FURNISHED BRASS DISC. IN ASPHALT ROADWAY, MONUMENT SHALL BE PER CITY STD DETAIL ST 21.
- R9 REMOVE EX CURB DRAIN OPENING, INCL. CONCRETE APRON, AND FRAME & COVER.

- R10 REMOVE EX ABANDONED WATER VALVE & BOX. CAP ABANDONED WATERLINE WITH SLURRY OR SAND FILL.
- R11 REMOVE EX WATER METER BOX AND INSTALL EBMUD-FURNISHED METER BOX AT NEW GRADE.
- R12 REMOVE & SALVAGE TO CITY YARD EX FLEXIBLE DELINEATOR POSTS.
- R13 REMOVE & REPLACE EX WV BOX WITH EBMUD SUPPLIED CHRISTY G5 VALVE BOX AND LID.
- P1 PROTECT IN PLACE EX PLANTER
- P2 PROTECT IN PLACE EX TREE
- P3 PROTECT IN PLACE EX BACKFLOW PREVENTER
- P4 PROTECT IN PLACE EX UTILITY POLE AND GUY WIRES
- P5 PROTECT IN PLACE EX STORM DRAIN INLET
- P6 PROTECT IN PLACE EX FIRE HYDRANT

- A1 ADJUST TO GRADE EX CLEANOUT BOX & COVER
- A2 LOWER & ADJUST TO GRADE EX STORM DRAIN MANHOLE
- A3 LOWER & ADJUST TO GRADE EX AT&T MANHOLE (BY AT&T)
- A4 LOWER & ADJUST TO GRADE EX WATER VALVE
- A5 LOWER & ADJUST TO GRADE EX GAS VALVE
- A6 LOWER & ADJUST TO GRADE EX SANITARY SEWER MANHOLE

GENERAL NOTES:

- ALL EXISTING FACILITIES SHALL BE PROTECTED IN PLACE, WHETHER SHOWN ON PLAN OR NOT, UNLESS OTHERWISE NOTED.
- EXISTING GUTTER IS OVERLAID WITH ASPHALT CONCRETE. APPROXIMATE GUTTER LOCATION IS SHOWN ON THE PLAN, BUT IT IS THE CONTRACTOR'S RESPONSIBILITY TO VERIFY THE EXISTING GUTTER LOCATIONS AND AVOID DAMAGING THE CURB AND GUTTER DURING MILLING AND COLD-IN-PLACE RECYCLING OPERATIONS.
- CONTRACTOR SHALL LOWER THE COVER/LID OF ALL UTILITIES WITHIN THE ROADWAY PRIOR TO PAVING OPERATIONS.

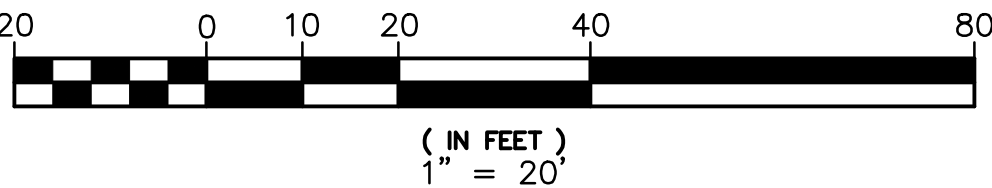

1-800-227-2600

Submittal / Revision:	
Designed By:	ES
Drawn By:	SY
Checked By:	DL
Date:	4/24/2025

Sheet Number:
C1.4
11 of 68